

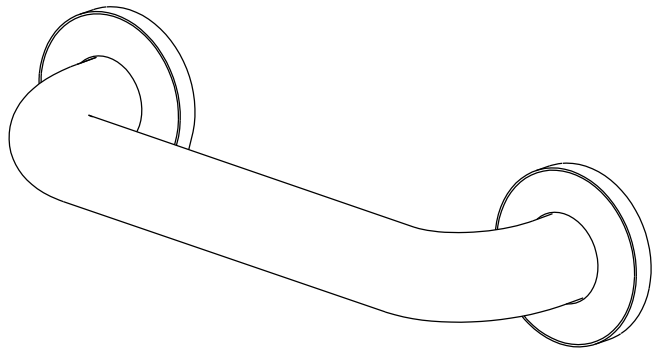

Grab Bar Installation

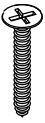

Parts:

| | | |
|---|--------------|--|
| Mounting Screw | | |
|  | MODEL | FINISH |
| 6 Pcs | CS | Stainless Steel, with Cover |
| | CT | Stainless Steel, with Cover, Textured |
| | ES | Stainless Steel, without Cover |
| | ET | Stainless Steel, without Cover, Textured |

www.eodfaucet.com
 TOLL-FREE CUSTOMER SERVICE: 877-FAUCET-1(328-2381)
 TECHNICAL SUPPORT E-mail: info@eodfaucet.com
 12775 Reservoir St., Chino, CA 91710

TOOLS REQUIRED

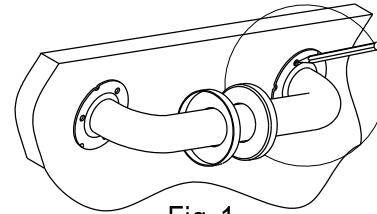

Fig. 1

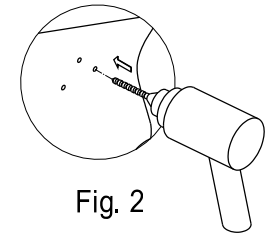

Fig. 2

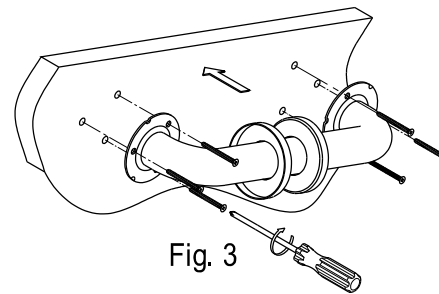

Fig. 3

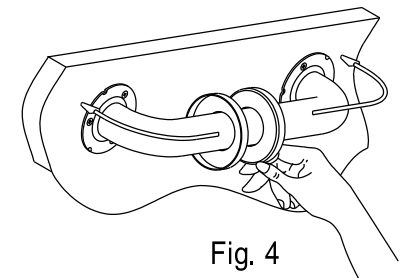

Fig. 4

Cleaning

Clean with a damp cloth only. Avoid using metal or abrasive polishes.

Installation Steps:

1. Locate position on the wall and mark location of the holes.
2. Drill Starter holes (5/64").
3. Mount grab bar to the wall using 2" screws (Enclosed).

This grab bar is designed to be installed on wood bracing, if a proper wood bracing is not available consult your contractor as to the best anchors to use for your specific application some options available are Tile/ masonry anchors, toggle bolts, plastic anchors, metal anchors and drywall anchors.